



EBARA

EBARA Dry Vacuum Pumps

Model EV-S

Innovative Technology.
Energy Savings Dry Vacuum Pump



Model EV-S

Ultimate energy conservation with a small footprint

Features

- Industry lowest power consumption
- Ultimately small footprint, lightweight
- Anti-corrosion design (-N type)
- On-demand operation function as a standard feature
- Digital & Analog signal communication with process tool
- CE marking, SEMI/NRTL available

■ Footprint comparison
(10,000 L / min class)

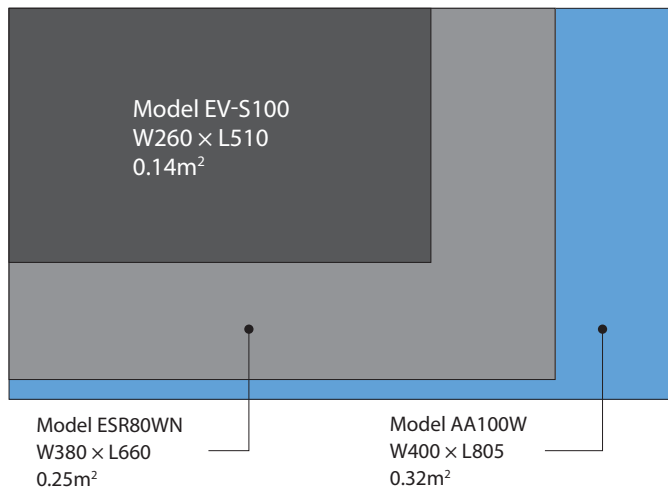

■ Power consumption comparison
(10,000 L / min class kWh at ultimate pressure)

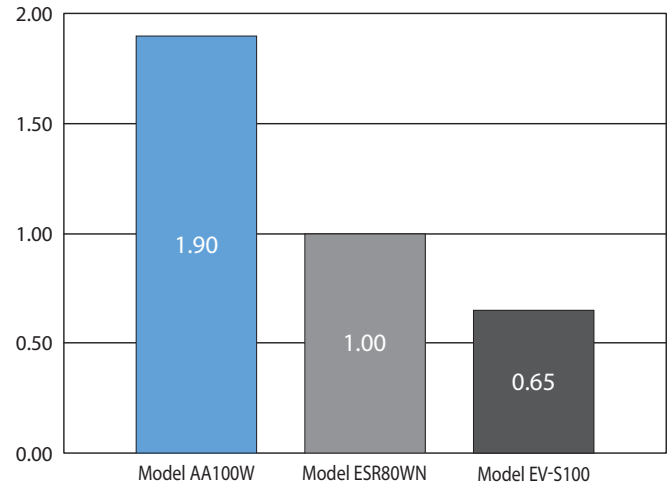

Applications

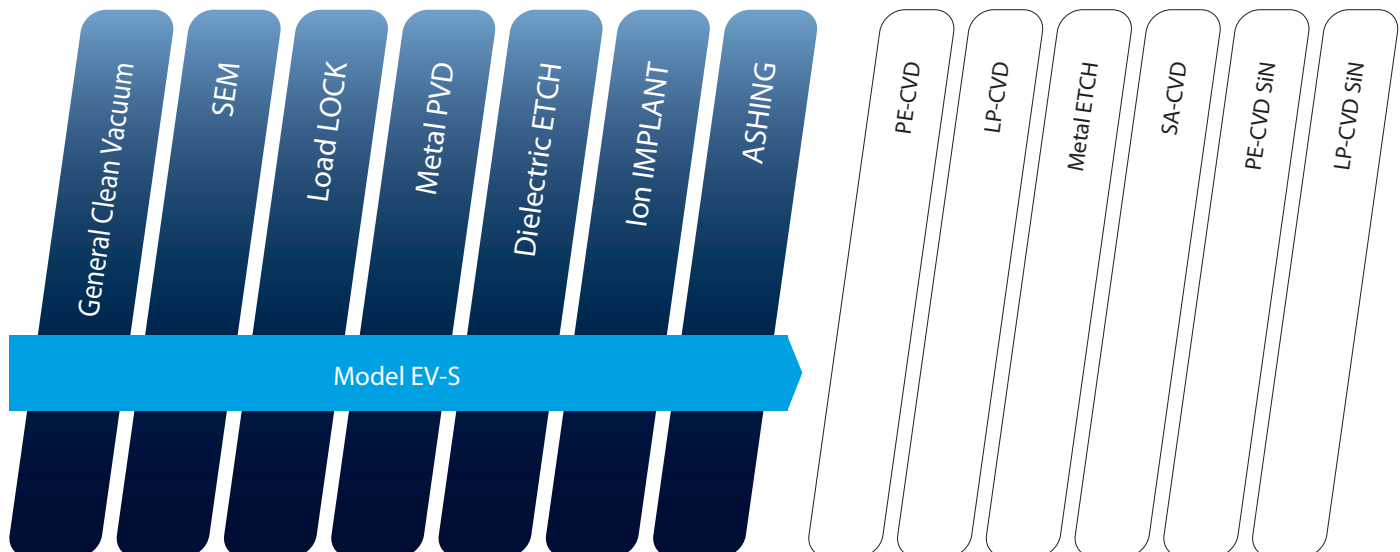

The EV-S Series are mostly applicable to clean vacuum applications, corrosive gas vacuum applications in Semiconductor process, LCD array processes, photovoltaic cell processes, LED and other general industries. (Harsh applications, generating chemical by-products, liquid are not applicable.)

Model Name Description

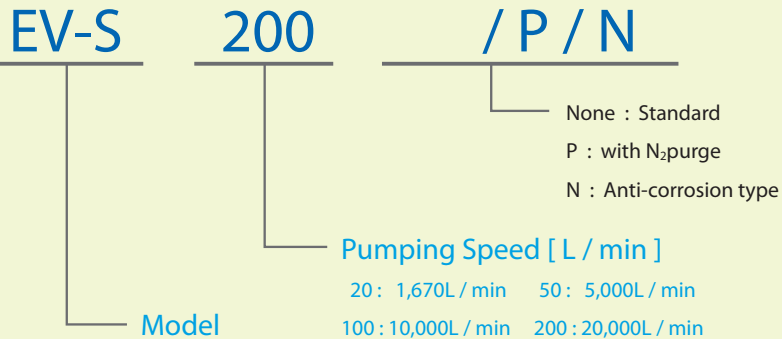

Product Line up and Specification

Model	EV-S20	EV-S20P/N	EV-S50	EV-S50P/N	EV-S100	EV-S100P/N	EV-S200	EV-S200P/N
Pumping Speed, L/min / CFM /	1,670L/min		5,000L/min		10,000L/min		20,000L/min	
Ultimate Pressure	3.0Pa	5.0Pa	0.5Pa	0.5Pa	0.5Pa	0.5Pa	0.5Pa	0.5Pa
Flange	Inlet	NW50		NW50		NW80		NW100
	Outlet	NW25		NW25		NW40		NW40
Power Consumption at ultimate pressure (Max Power)	0.4kW (2.2kW)		0.55kW (3.6kW)		0.65kW (4.6kW)		0.75kW (5.1kW)	
Cooling Water	Connection	Rc 1/4 (Coupler)						
	Supply Pressure (Gauge pressure)	Differential Pressure: Min. 0.2MPa, Supply Pressure: Max. 0.4MPa						
	Flow Rate	1.5~3.0L/min				2.0~3.0L/min		
	Temperature	< 30						
N ₂	Connection	—	1/4" Tube Connection	—	1/4" Tube Connection	—	1/4" Tube Connection	—
	Supply Pressure (Gauge pressure)	—	Supply Pressure: 0.15-0.7MPa Regulator Setting: 0.09-0.12MPa	—	Supply Pressure: 0.15-0.7MPa Regulator Setting: 0.09-0.12MPa	—	Supply Pressure: 0.15-0.7MPa Regulator Setting: 0.09-0.12MPa	—
	Approx Flow Rate (@ N ₂ 0-Mode)	—	17-20Pa·m ³ /s (2.4Pa·m ³ /s)	—	17-20Pa·m ³ /s (2.4Pa·m ³ /s)	—	17-20Pa·m ³ /s (2.4Pa·m ³ /s)	—
Ventilation	Connection	—	φ 50mm	—	φ 50mm	—	φ 50mm	—
	Ventilation Pressure	—	-196Pa	—	-196Pa	—	-196Pa	—
	Approx Flow Rate	—	0.5m ³ /min	—	0.5m ³ /min	—	0.5m ³ /min	—
Power	Phase / Voltage / Hz	3P / 200-220V(50/60Hz) / 380-440V(50/60Hz)						
	Breaker Size	3.2kVA		4.8kVA		6.4kVA		6.8kVA
Approx Weight, kg (lb)	60 (132)		100 (220)		120 (265)		170 (375)	

Model EV-S

Options

	PART	DESCRIPTION	REMARKS
1	Additional N ₂ Purge Valve	N ₂ gas purge control	Model EV-S20(P/N) is not applicable
2	Electrical Noise Shielding	Prevent malfunction caused by electrical noise generated from process tools, facility.	—
3	LCD Distribution Unit (20m)	Extendable LCD controller situated at remote area.	—
4	L-shape pump fixture	Securely fix the pump on floor.	Anchor plate is a standard parts for CE/SEMI/NRTL version.
5	Signal Interface Panel	Signal converter to properly communicate with process tool.	Configuration is built according to requirements of each process tool.
6	Power Cable	—	—
7	Control Signal Cable	—	—

Pumping Curves

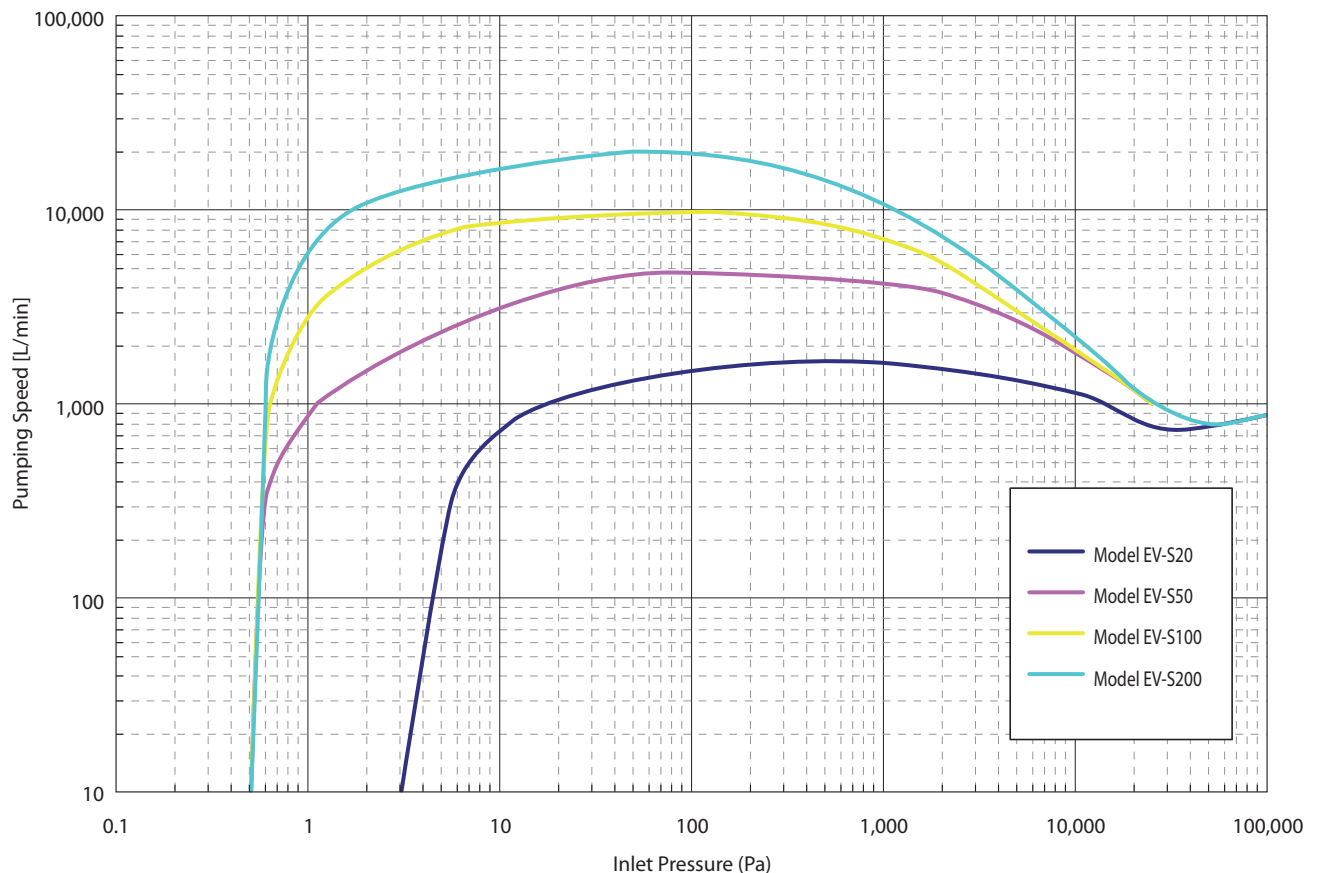

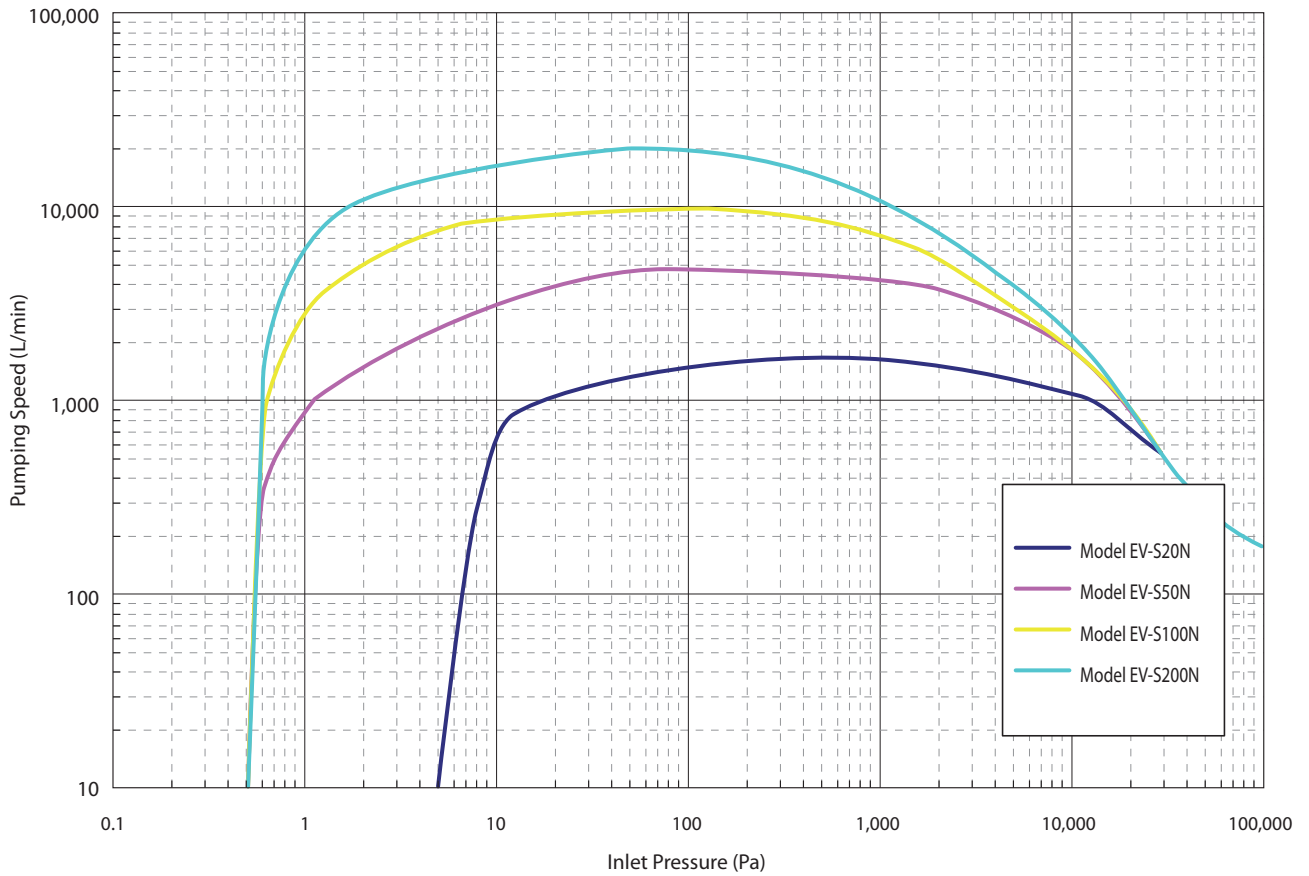
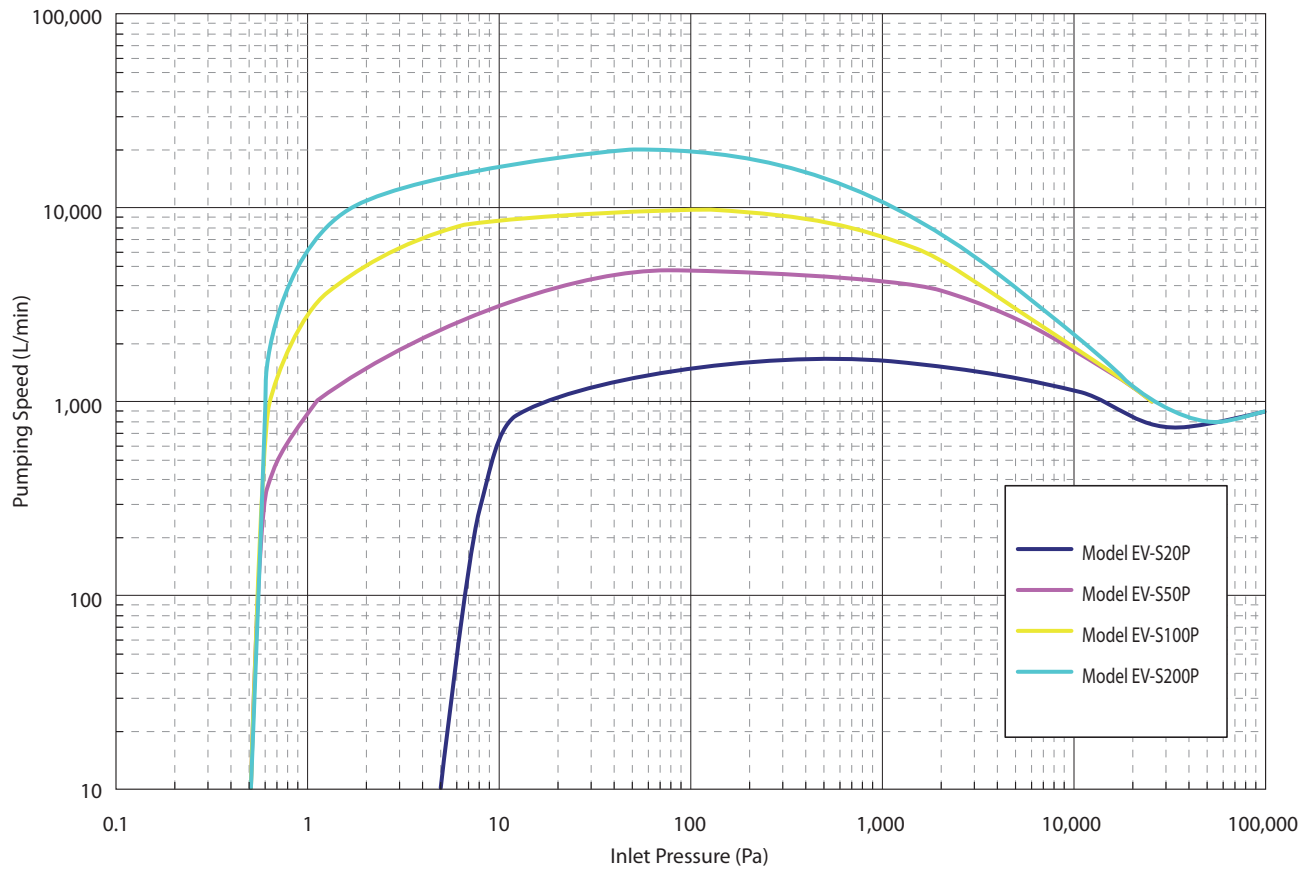

Model EV-S

Dimension (mm)

200V Version Model EV-S 20P/N

Model EV-S 20 does not have N₂ purge port, regulator, regulator gauge, ventilation port and N₂ purge flow control valve.

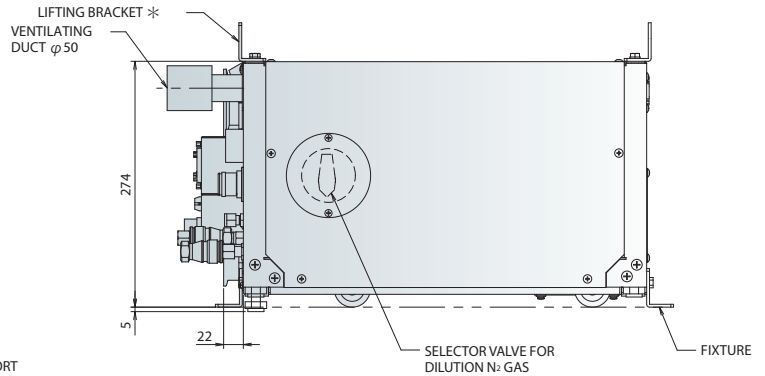
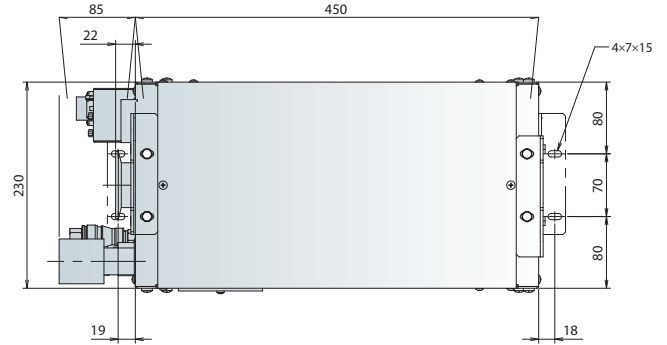
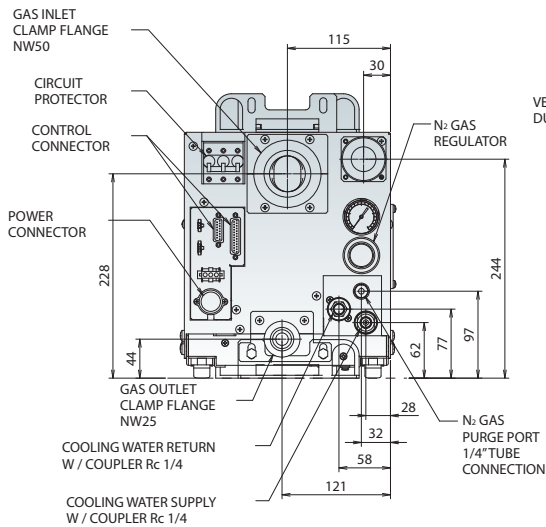

* LIFTING BRACKET CAN BE USE FOR FIXTURE

200V Version Model EV-S 50P/N

Model EV-S 50 does not have N₂ purge port, regulator, regulator gauge, ventilation port and N₂ purge flow control valve.

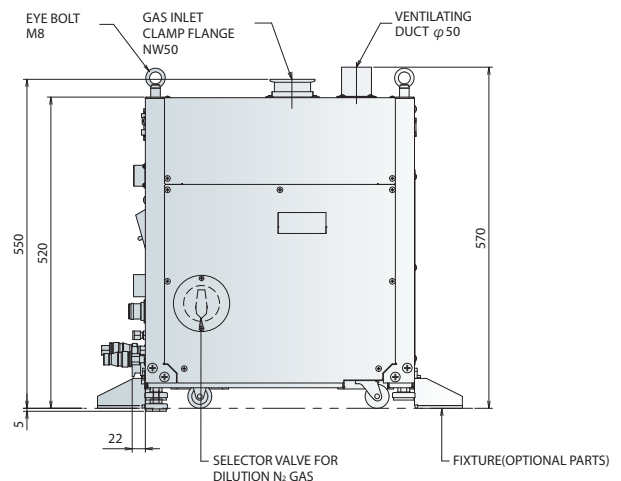
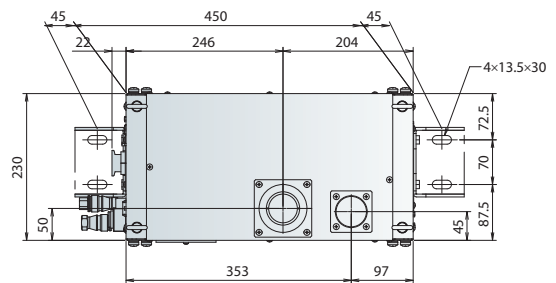
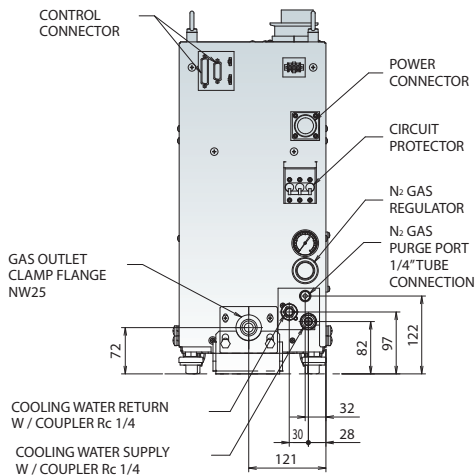

200V Version Model EV-S 100P/N

Model EV-S 100 does not have N₂ purge port, regulator, regulator gauge, ventilation port and N₂ purge flow control valve.

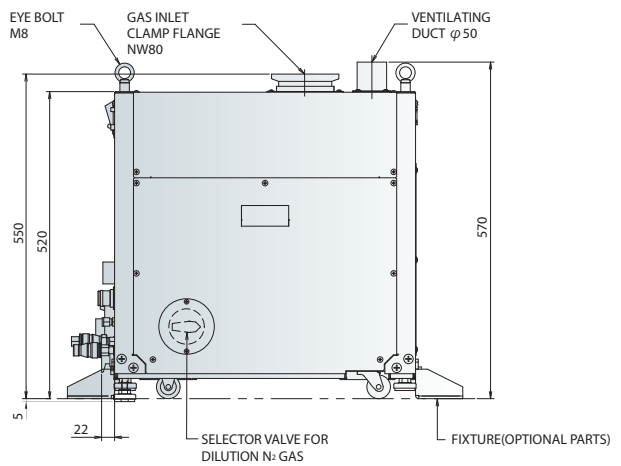
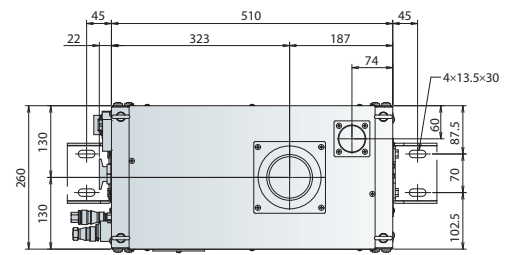
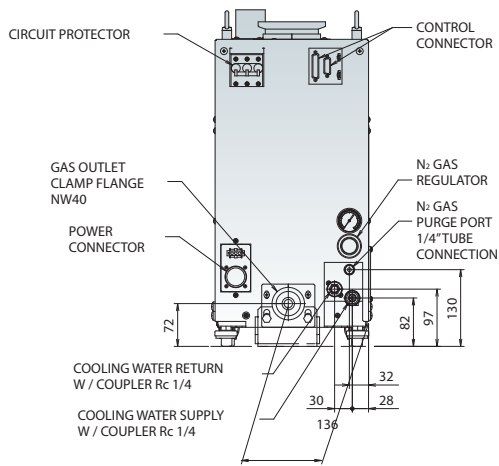

200V Version Model EV-S 200P/N

Model EV-S 200 does not have N₂ purge port, regulator, regulator gauge, ventilation port and N₂ purge flow control valve.

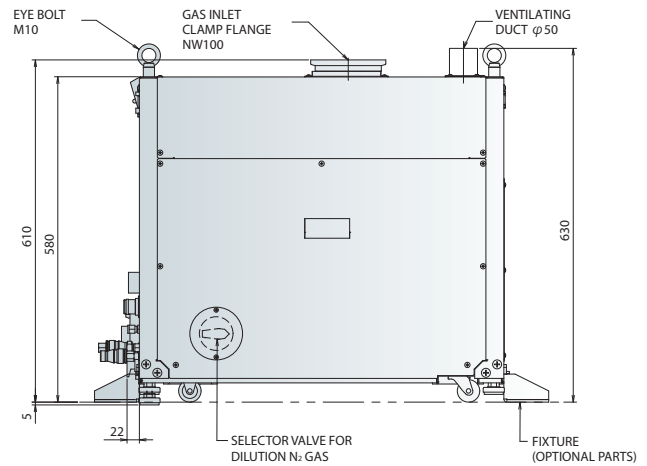
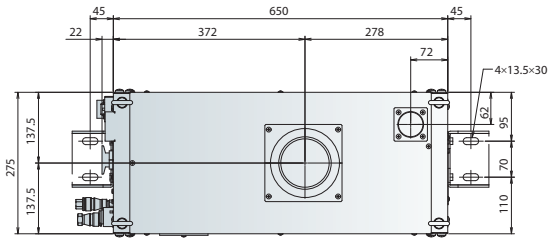
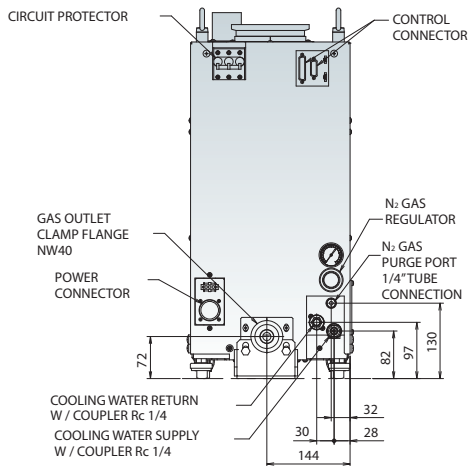

**EBARA Technologies, Inc.**www.ebaratech.com

51 Main Avenue, Sacramento, California 95838 — Phone: 1-800-535-5376 Fax: 1-916-925-6654

EBARA Corporation Precision Machinery Companywww.ebara.com/en/business/precision

2-1, Hon-Fujisawa 4-chrome, Fujisawa Kanagawa, 251-8502, Japan — Phone: 81-466-83-9000 Fax: 81-466-83-1100

EBARA Field Tech. Corporationwww.eft.ebara.com

2-1, Hon-Fujisawa 4-chrome, Fujisawa Kanagawa, 251-8502, Japan — Phone: 81-466-83-9171 Fax: 81-466-83-1100

GLOBAL NETWORK**U.S.A.**

EBARA Technologies, Inc.
Headquarters: Sacramento, CA
FSC: Sacramento, CA
QRC: San Jose, CA
E. Fishkill, NY
Manassas, VA
S. Portland, ME
Hillsboro, OR
Newburyport, MA

EUROPE

EBARA Precision Machinery Europe
GmbH
Headquarters: HANAU, Germany
FSC: Livingston, UK
QRC: Dresden, Germany
Evry, France
Meyreuil, France
Kildare, Ireland
Haifa, Israel

JAPAN

EBARA Corporation
Precision Machinery Company
Headquarters: Fujisawa, Japan
FSC: Tohoku Fukushima
Hokuriku Toyama
Chubu Mie
Kyusyu Fukuoka
QRC: Kitami Iwate
Tohoku Miyagi
Ibaraki
Chubu Mie
Osaka
Hiroshima
Shikoku Ehime
Fukuoka
Oita
Kumamoto

KOREA

EBARA Precision Machinery KOREA INC
Headquarters: Seoul
FSC: Mogok-Dong

CHINA

Shanghai EBARA Precision Machinery Co.,
LTD
Headquarters: Shanghai
FCS: Shanghai
QRC: Wuxi

TAIWAN

EBARA Precision Machinery TAIWAN INC
Headquarters: Taipei
FSC: Hu-ko
QRC: Linkou
Taichung
Tainan

SINGAPORE

EBARA Engineering Singapore Pte. Ltd.
Headquarters: Tuas Link
FSC: Tuas Link

Patent Pending

UL® and C-UL® are registered trademarks of Underwriter's Laboratories, Inc.

"Model EV-S" is our model code.

All specifications are subject to change without notice.

© EBARA Technologies, Inc. | 2014 Printed in USA



0182-B1009072, Rev. C