



EBARA

EBARA Dry Vacuum Pumps

Model EV-M

Innovative Technology

For Harsh Condensable processes, featuring compact size and energy efficient pumps



Ebara EV-M

The Model EV-M series are dry vacuum pumps designed for harsh process applications featuring unique temperature control and on demand torque operation. The EV-M series is capable of processing harsh and light duty applications with a wide range of pumping speeds. Designed to consume much less power than previous pumps, a combination of root rotor arrangement and high torque motors and inverters makes the EV-M series more energy efficient and an ideal solution for harsh process.



EV-M802N

Features and Benefits



Ideal for Harsh Process



Reduced Installation Space



Industry Leading Performance



Environmentally Responsive



Energy Efficient Savings



High Torque Motor



Lowest Cost of Ownership



CE / SEMI/ NRTL Rated

Pumping Curves

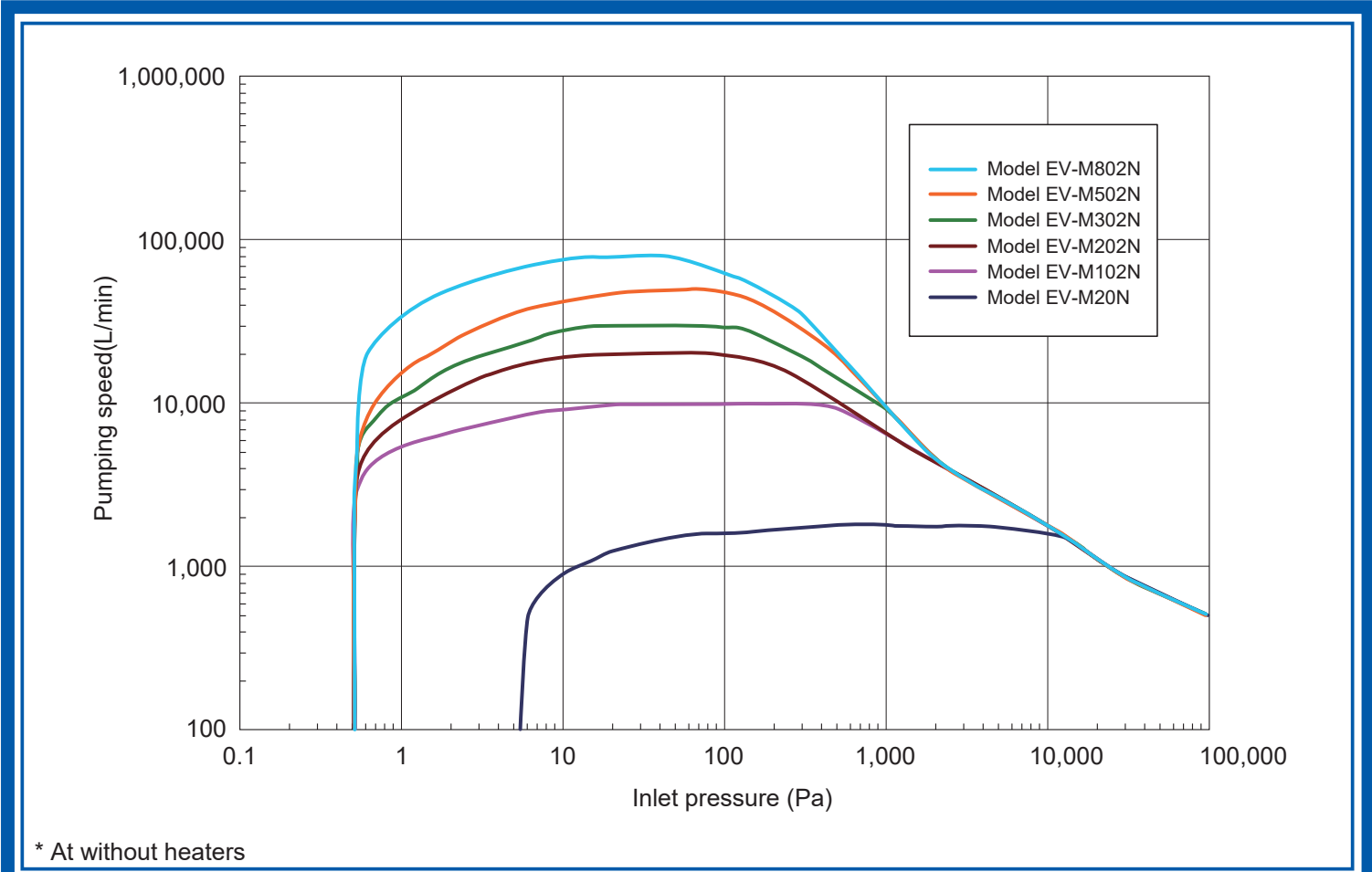

Accessories

Exhaust Check Valve

Emergency Stop Button

Exhaust Pipe Heater

LCD Controller

Tool Interface

Specifications

MODEL		EV-M20N EV-M102N EV-M202N EV-M302N EV-M502N EV-M802N					
Pumping Speed	L/min	1,800	10,000	20,000	30,000	50,000	80,000
Ultimate Pressure	Pa	5.0	0.5				
Connection	Gas Inlet	NW 40	ISO 100			ISO 160	ISO 200
	Gas Outlet	NW 40					
Approx Power at Ultimate Pressure	kW	1.2	1.8	1.9	2.3	2.1	2.8
Cooling Water	Flow Rate	L/min	3-8		3.5-8	4-8	5-8
	Temperature	°C	Max 30				
N2 Gas	Approx Flow Rate	Pa*m ³ /s	26-31			28-33	
Power Supply	Phase / Volt / Frequency	200 V	3Phase / 200V / 50 Hz				
			3Phase / 200-220V / 60 Hz				
		400 V	3Phase / 380-400V / 50 Hz				
			3Phase / 380-440V / 60 Hz				
		460 V	3Phase / 440-460V / 50 Hz				
			3Phase / 440-480V / 60 Hz				
Power Capacity	kVA	3.30	5.4	6	6.8	7.1	8.3
Weight	kg	170	320	360	400	500	740

Model EV-M Typical Application

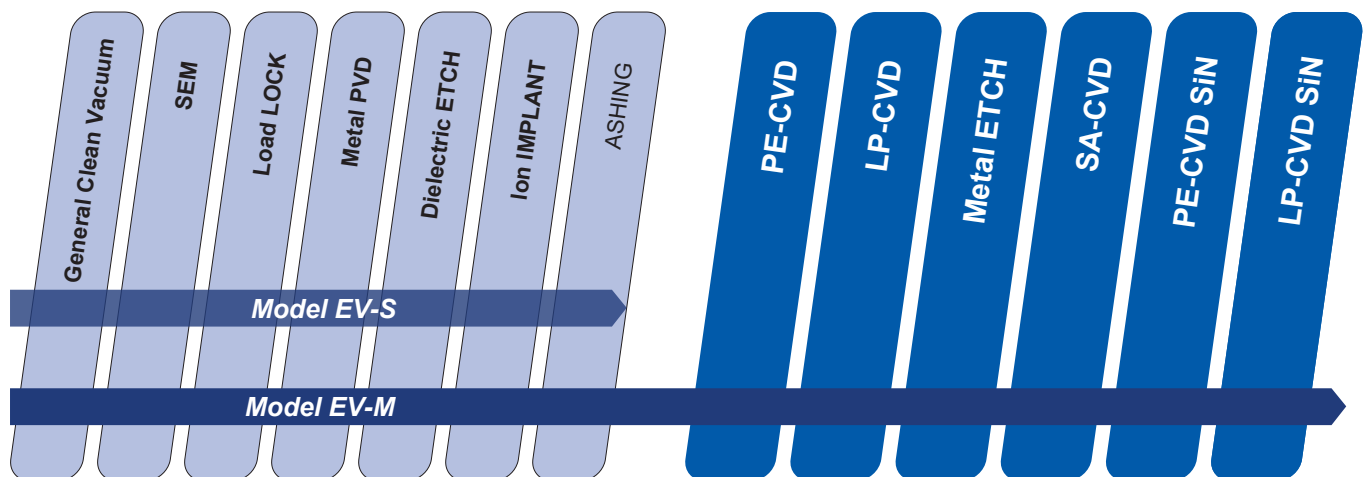

Model EV-M can be used for many vacuum applications in semiconductor, FPD, PV and other industries.
 Model EV-M is unsuitable for fluid and powder pumping applications.

Drawings

EV-M20N

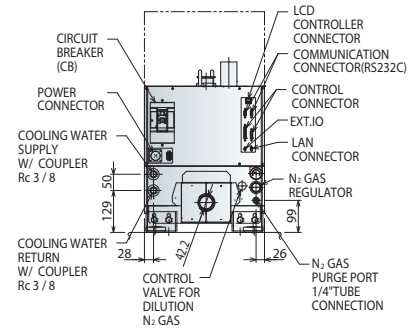
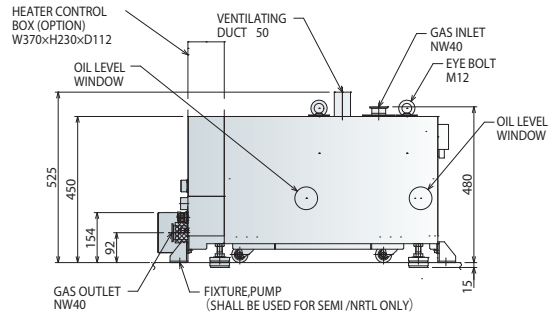
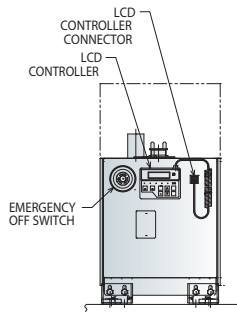
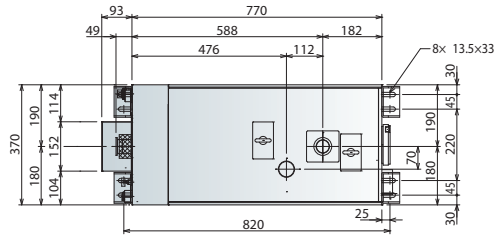

☒:HEAT INSULATOR

EV-M102N

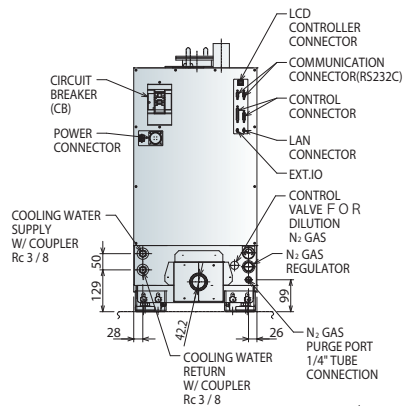
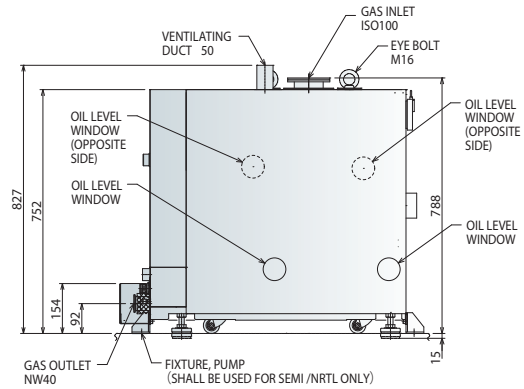
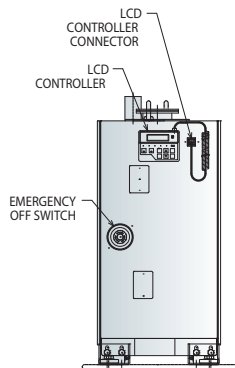
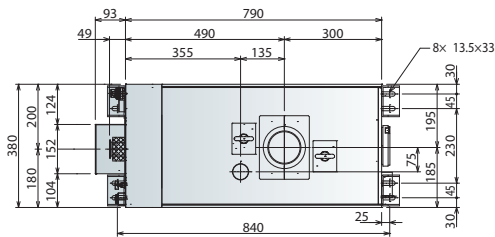

☒:HEAT INSULATOR

Drawings

EV-M202N

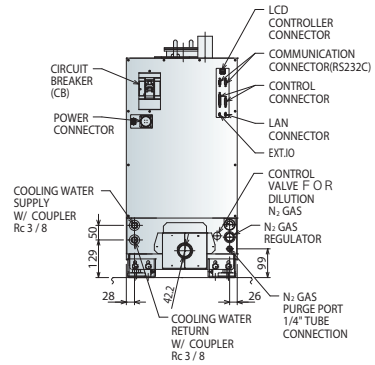
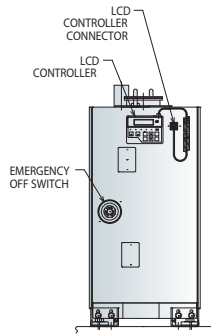
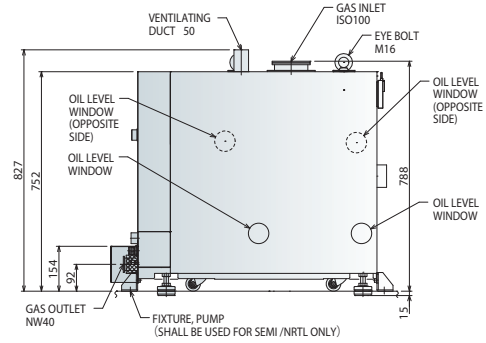
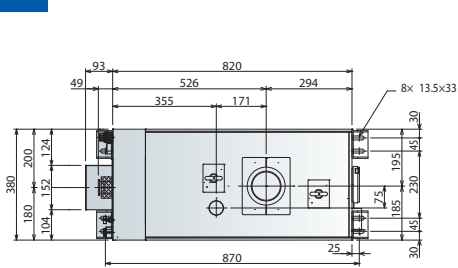

☒:HEAT INSULATOR

EV-M302N

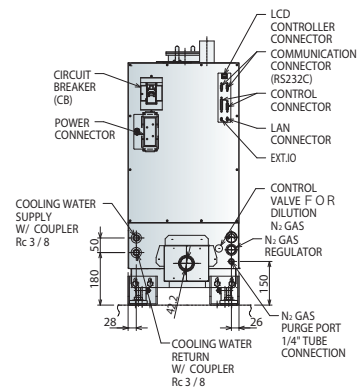
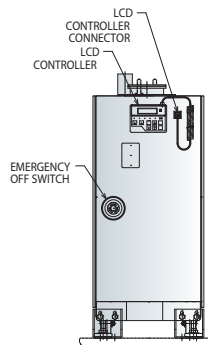
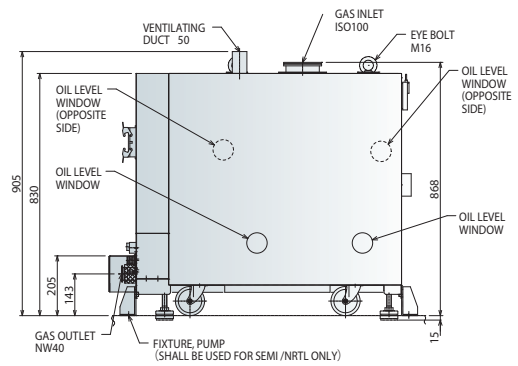
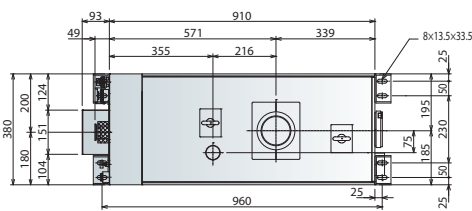

☒:HEAT INSULATOR

Drawings

EV-M502N

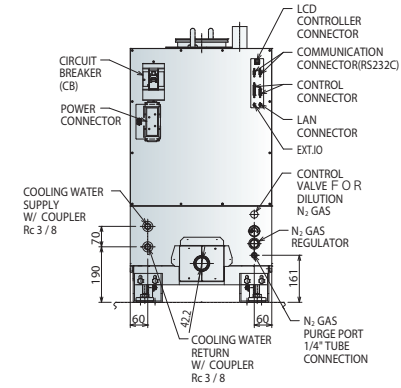
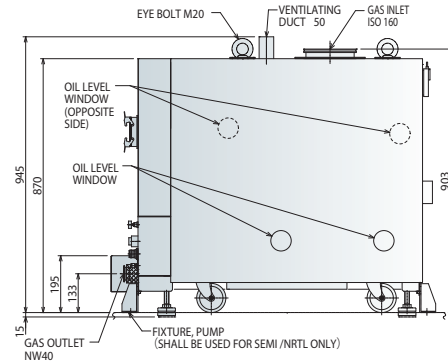
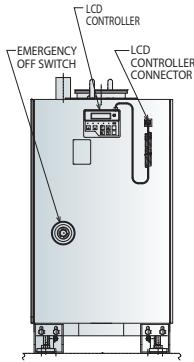
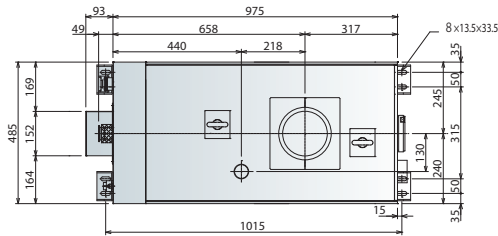

HEAT INSULATOR

EV-M802N

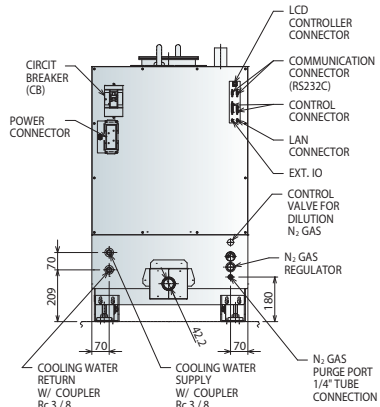
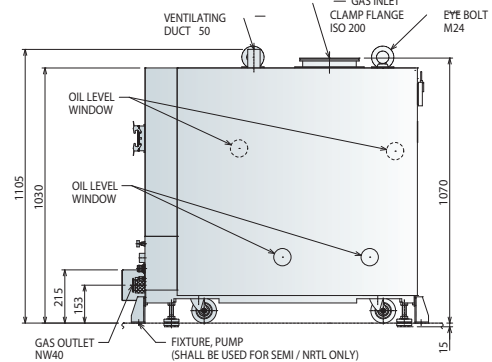
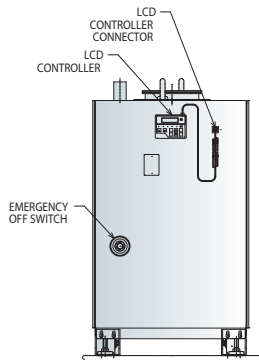
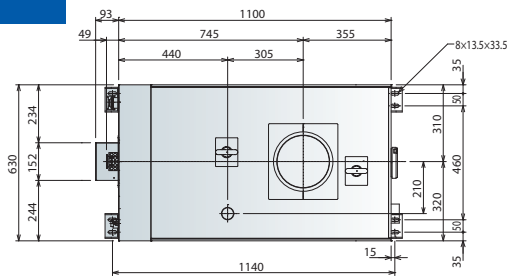

HEAT INSULATOR

Please inquire about an outside drawing of 400/460V specification separately.

**EBARA Technologies, Inc.**www.ebaratech.com

51 Main Avenue, Sacramento, California 95838 — Phone: 1-800-535-5376 Fax: 1-916-925-6654

EBARA Corporation Precision Machinery Companywww.ebara.com/en/business/precision

2-1, Hon-Fujisawa 4-chrome, Fujisawa Kanagawa, 251-8502, Japan — Phone: 81-466-83-9000 Fax: 81-466-83-1100

EBARA Field Tech. Corporationwww.eft.ebara.com

2-1, Hon-Fujisawa 4-chrome, Fujisawa Kanagawa, 251-8502, Japan — Phone: 81-466-83-9171 Fax: 81-466-83-1100

GLOBAL NETWORK**U.S.A.**

EBARA Technologies, Inc
Headquarters: Sacramento, CA
FSC: Sacramento, CA
QRC: San Jose, CA
E. Fishkill, NY
Hillsboro, OR
Newburyport, MA

EUROPE

EBARA Precision Machinery Europe GmbH
Headquarters: HANAU, Germany
FSC: Livingston, UK
QRC: Dresden, Germany
Evry, France
Meyreuil, France
Kildare, Ireland
Haifa, Isreal

JAPAN

EBARA Corporation Precision Machinery Company
Headquarters: Fujisawa, Japan
FSC: Tohoku Fukushima
Hokuriku Toyama
Chubu Mie
Kjusyu Fukuoka
QRC: Kitami Iwate
Tohoku Miyagi
Ibaraki
Chubu Mie
Osaka
Hiroshima
Shikoku Ehime
Fukuoka
Oita
Kumamoto

KOREA

EBARA Precision Machinery KOREA INC
Headquarters: Seoul
FSC: Mogok-Dong

CHINA

Shanghai EBARA Precision Machinery Co., LTD
Headquarters: Shanghai
FCS: Shanghai
QRC: Wuxi

TAIWAN

EBARA Precision Machinery TAIWAN INC
Headquarters: Taipei
FSC: Hu-ko
QRC: Linkou
Taichung
Tainan

SINGAPORE

EBARA Engineering Singapore Pte. Ltd.
Headquarters: Tuas Link
FSC: Tuas Link

Patent Pending

UL® and C-UL® are registered trademarks of Underwriter's Laboratories, Inc.

"Model EV-M" is our model code.

All specifications are subject to change without notice.

© EBARA Technologies, Inc. | 2019 Printed in USA

0182-D1902214, Rev A